

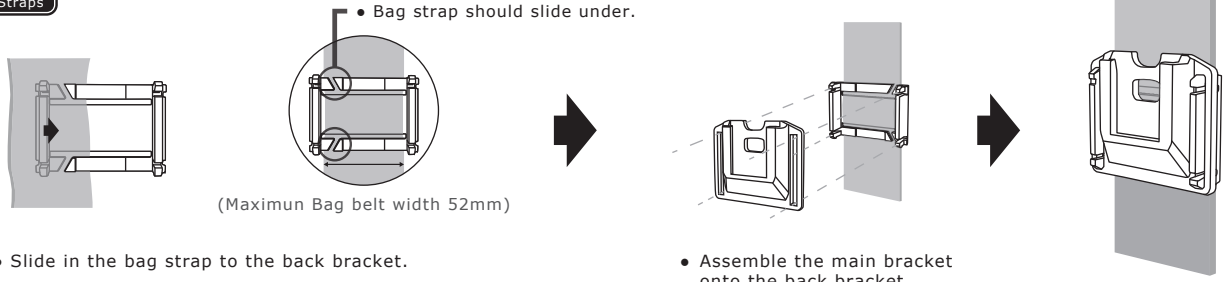

1 Install on the Straps



• Slide in the bag strap to the back bracket.

• Assemble the main bracket onto the back bracket.



2 Install on the Belts

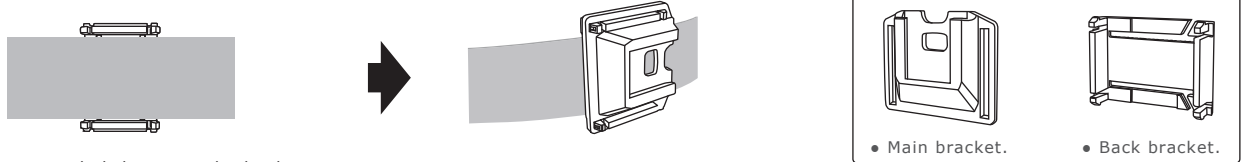

• Place your belt between the back bracket and main bracket.



3 Install on the Arm

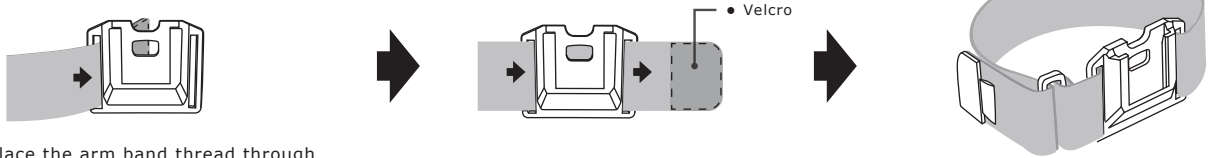

• Place the arm band thread through the 2 holes on the main bracket.



1 Install on the Straps

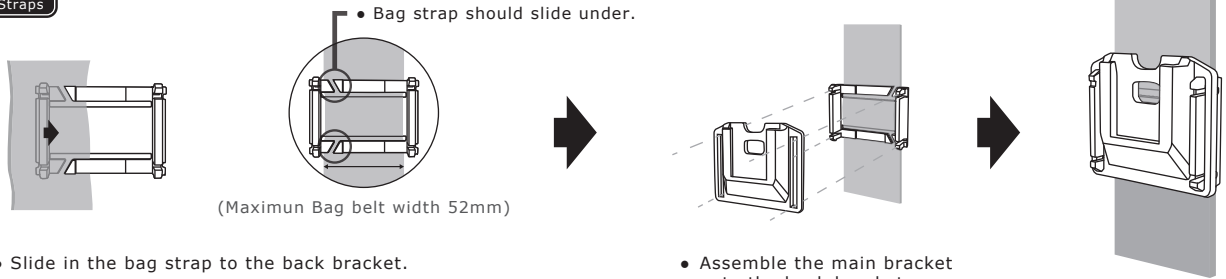

• Slide in the bag strap to the back bracket.

• Assemble the main bracket onto the back bracket.



2 Install on the Belts

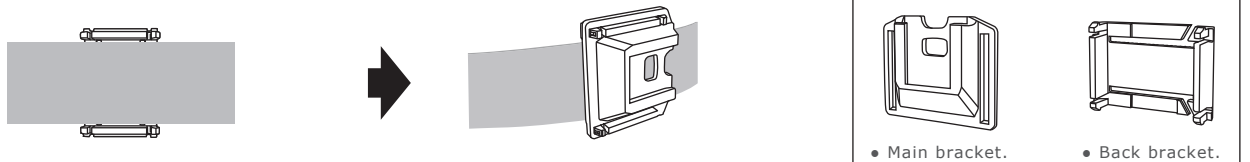

• Place your belt between the back bracket and main bracket.



3 Install on the Arm

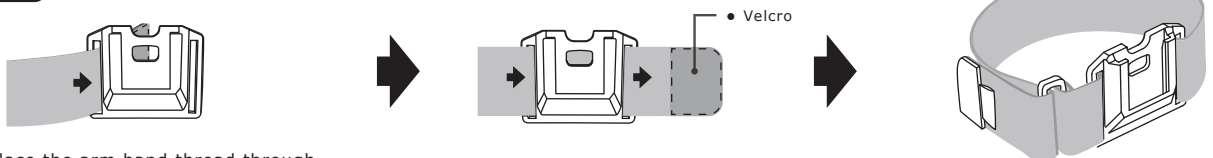

• Place the arm band thread through the 2 holes on the main bracket.